

CRV1 + CPS

80, 90, 100, 80, 90, 100,

GB INSTALLATION INSTRUCTIONS

DE MONTAGEANLEITUNG

PL INSTRUKCJA MONTAŻU

HU SZERELÉSI UTASÍTÁS

RU ИНСТРУКЦИЯ ПО МОНТАЖУ

UA ІНСТРУКЦІЯ З МОНТАЖУ

BG УПЪТВАНЕ ЗА МОНТАЖ

ES INSTRUCCIONES DE MONTAJE

FR INSTRUCTIONS DE MONTAGE

RO INSTRUCȚIUNI DE MONTAJ

SK MONTÁŽNY NÁVOD

CZ MONTÁŽNÍ NÁVOD

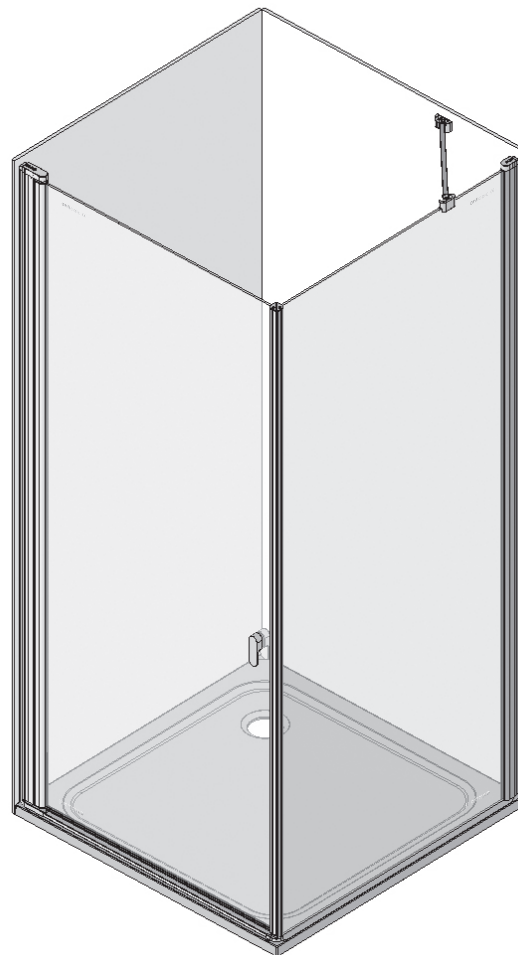

RAVAK®

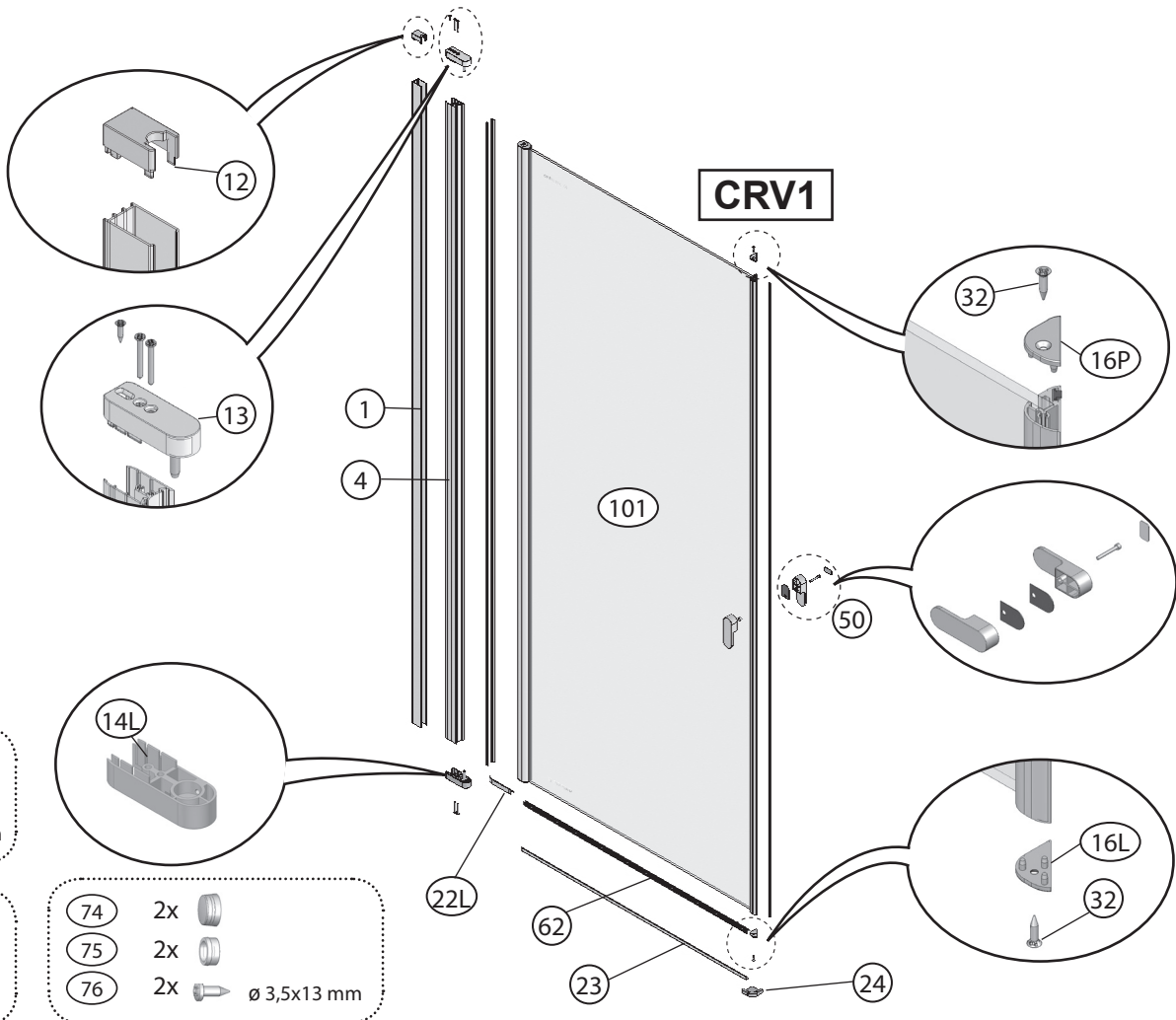
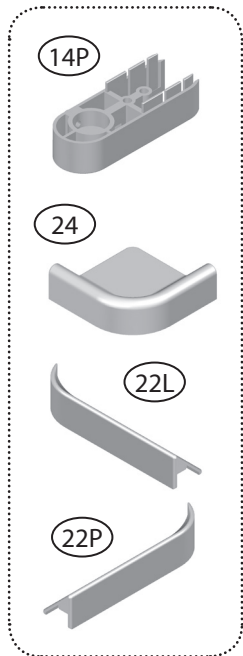

- 71 3x ø8
- 72 3x 4x40
- 73 1x ø 3 mm

- 77 1x 3,5x13
- 1x 2 mm

- 74 2x
- 75 2x
- 76 2x ø 3,5x13 mm

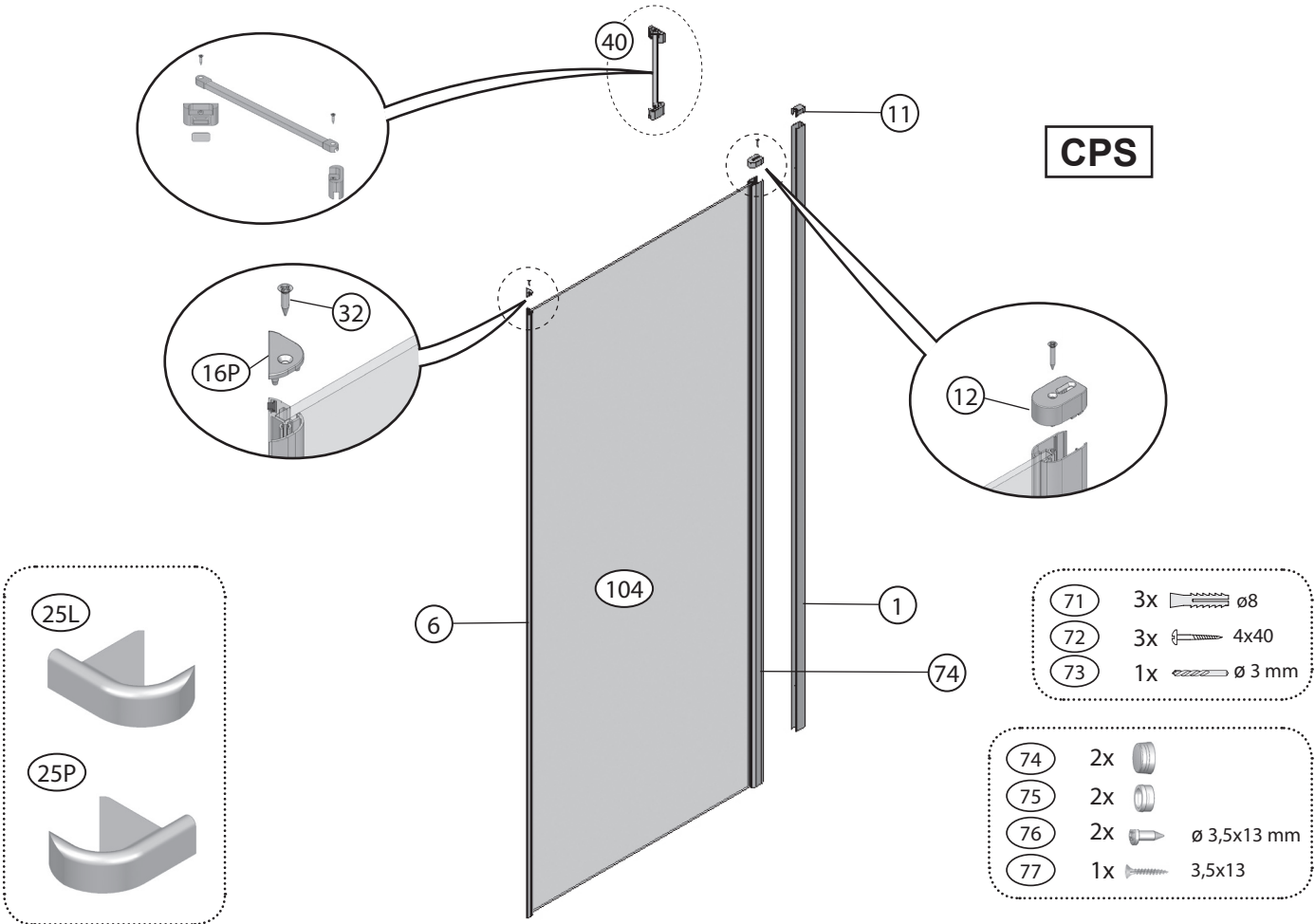

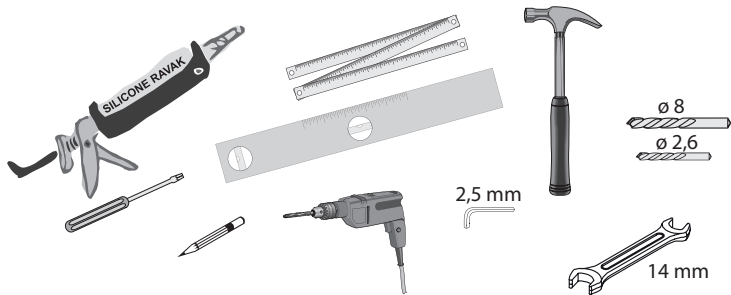
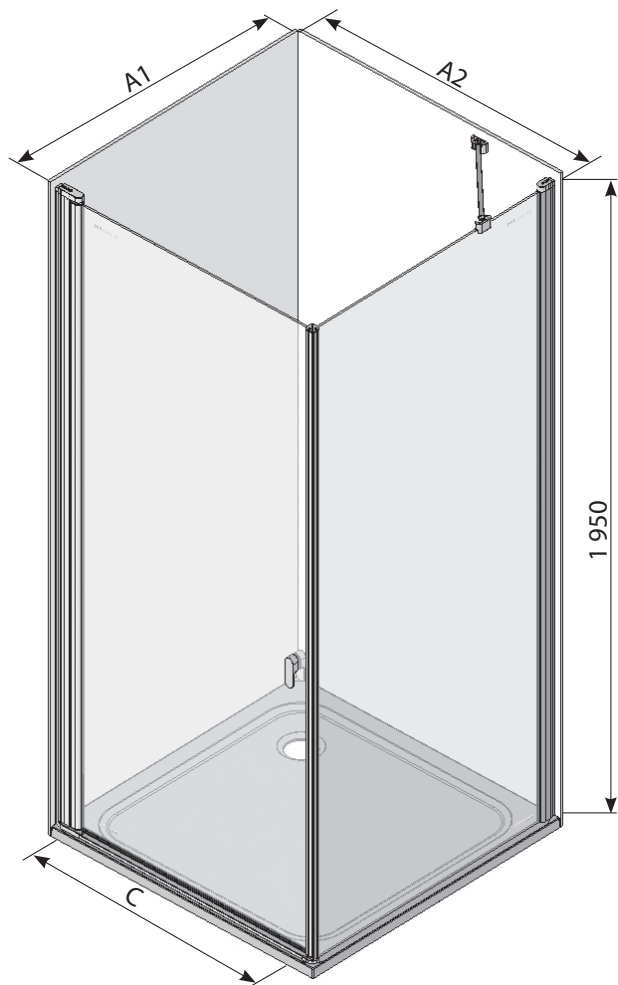

TYP	A1	A2	B1	B2	C	D1	D2
CPS-80 +CRV1-80	780-800	780-800	800	800	680	770	770
CPS-90 +CRV1-90	880-900	880-900	900	900	780	870	870
CPS-100+CRV1-100	980-1000	980-1000	1000	1000	880	970	970
CPS-80+CRV1-100	780-800	980-1000	800	1000	880	770	970

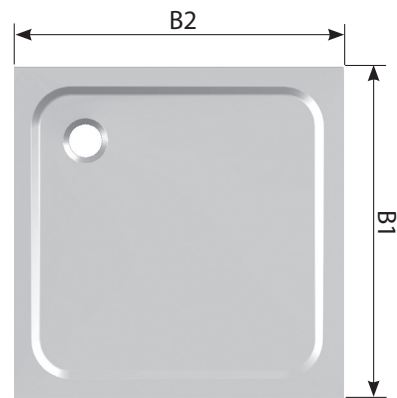

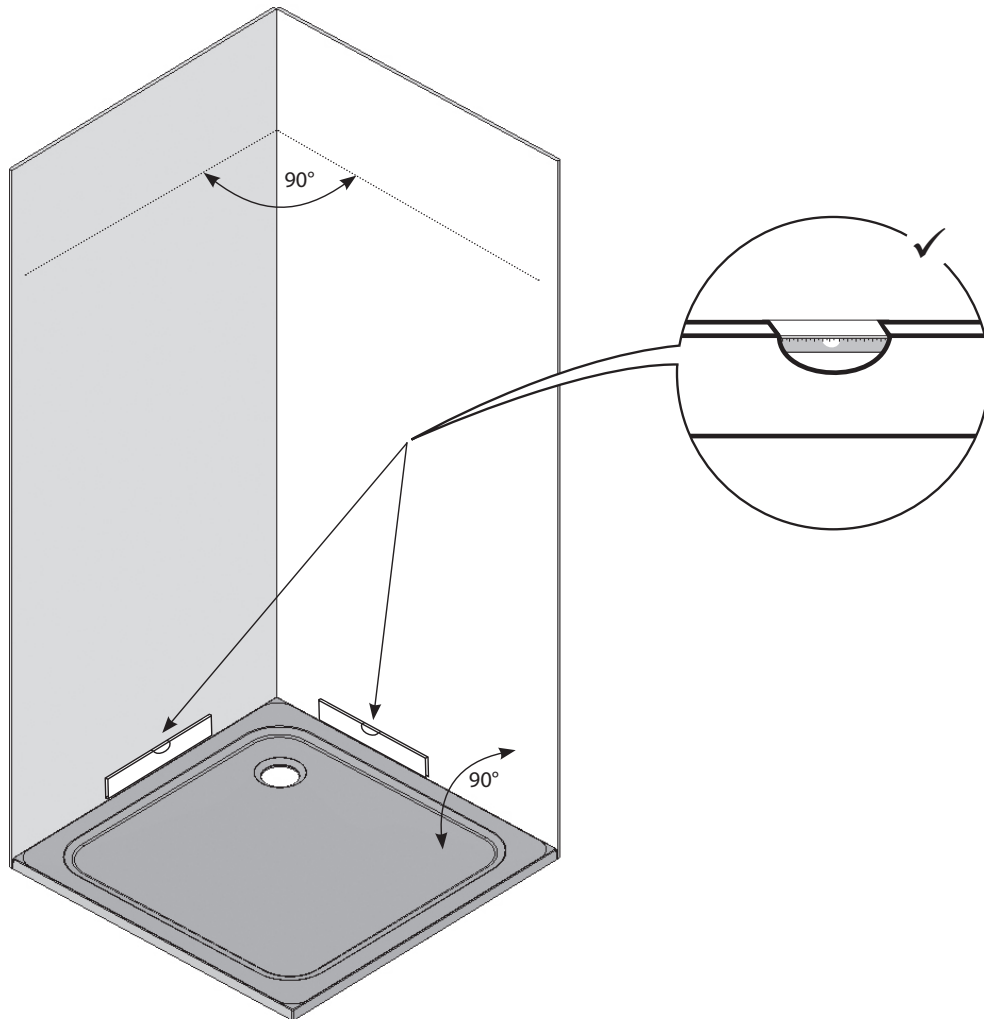

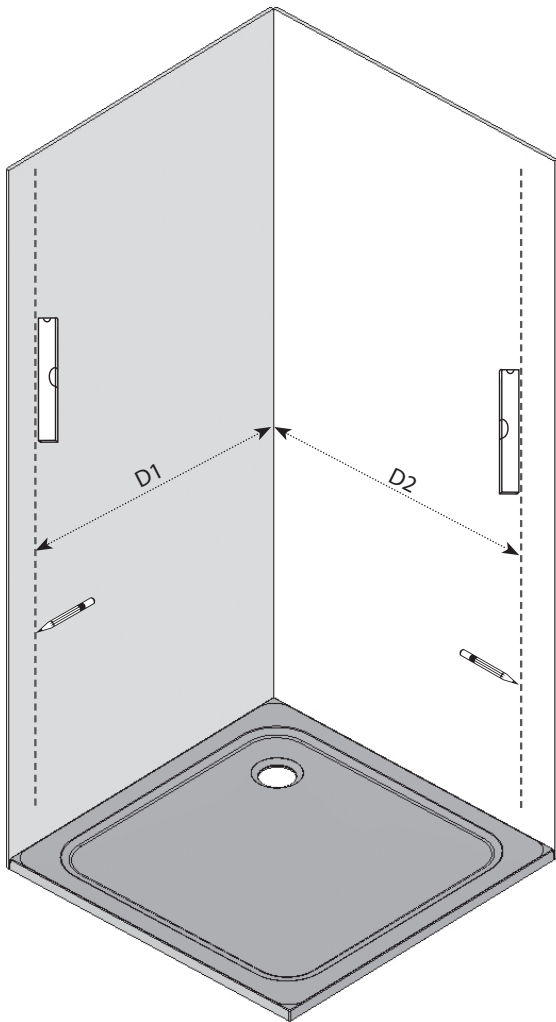

TYP	A1	A2	B1	B2	C	D1	D2
CPS-80 +CRV1-80	780-800	780-800	800	800	680	770	770
CPS-90 +CRV1-90	880-900	880-900	900	900	780	870	870
CPS-100+CRV1-100	980-1000	980-1000	1000	1000	880	970	970
CPS-80+CRV1-100	780-800	980-1000	800	1000	880	770	970

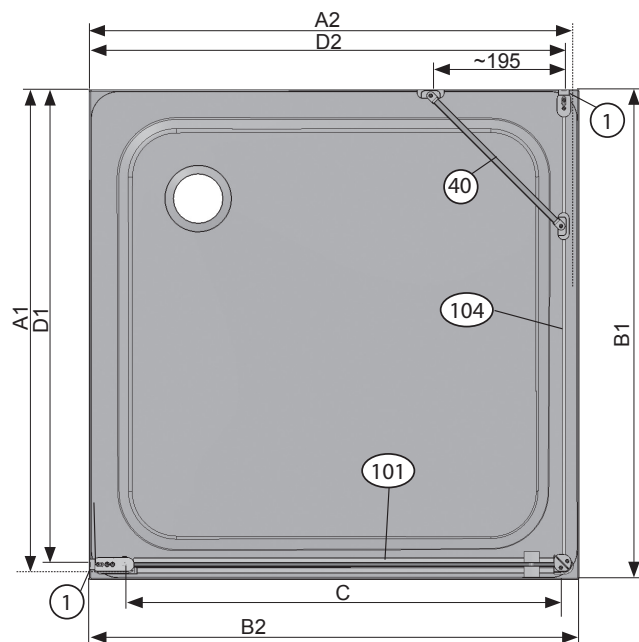

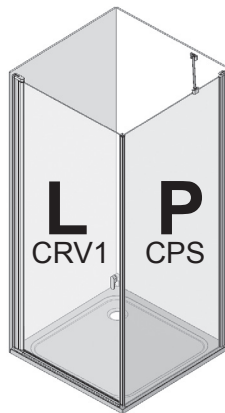
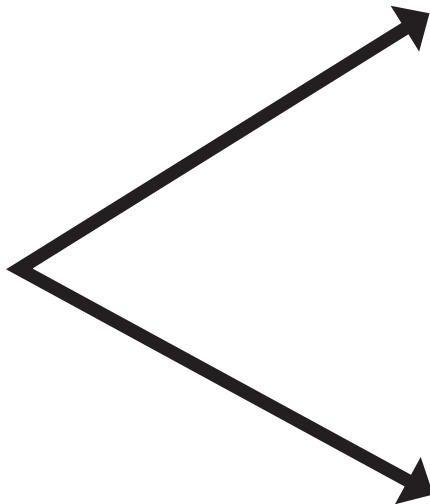
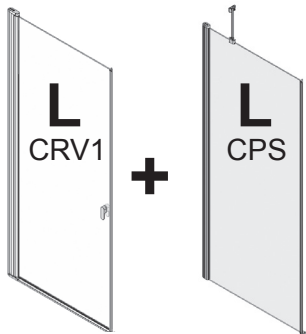

⇒ 7

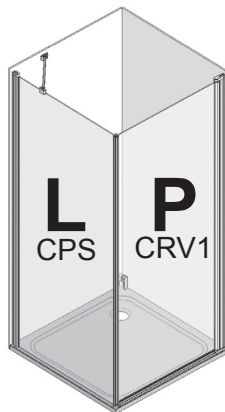

⇒ 15

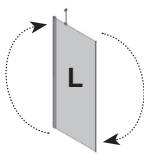
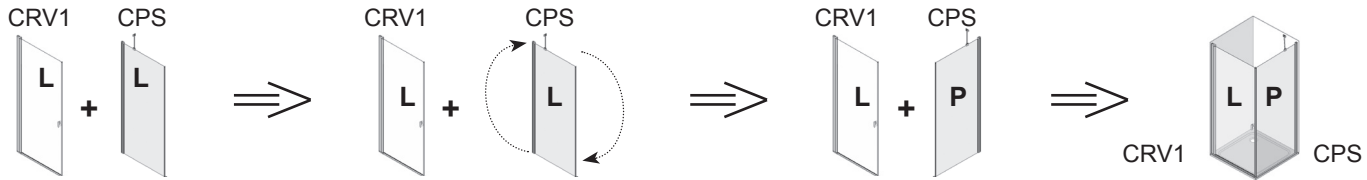

How to make right side fixed wall from one left side fixed wall.

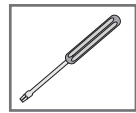

1

CPS

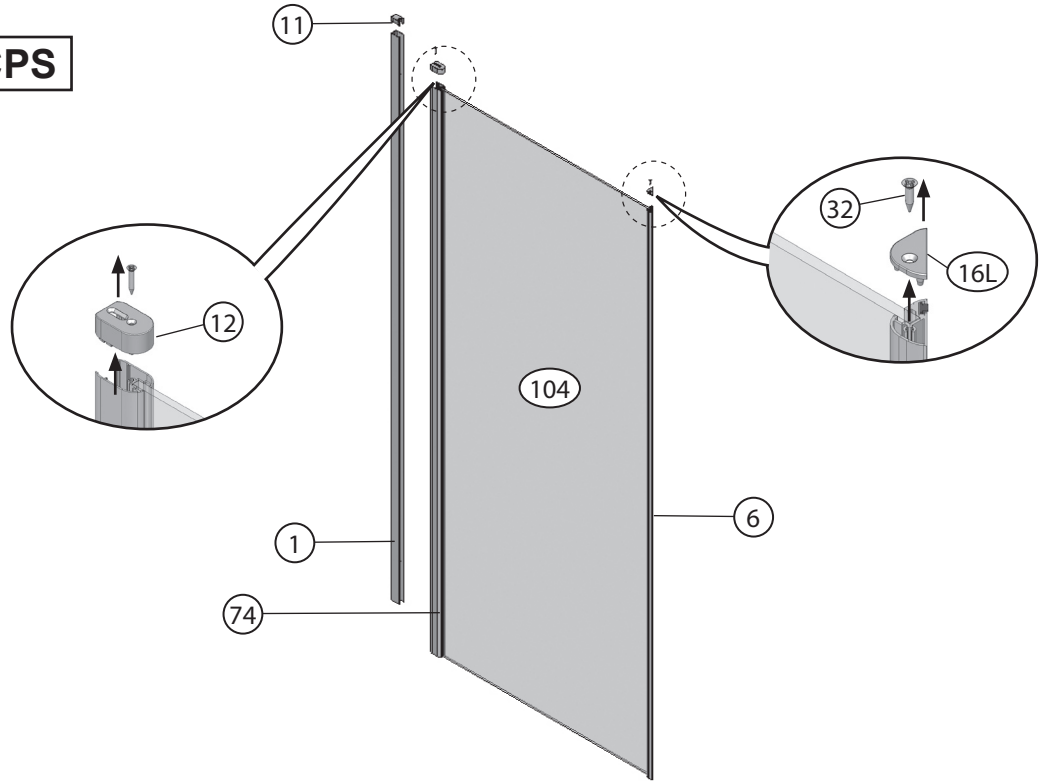

2

CPS

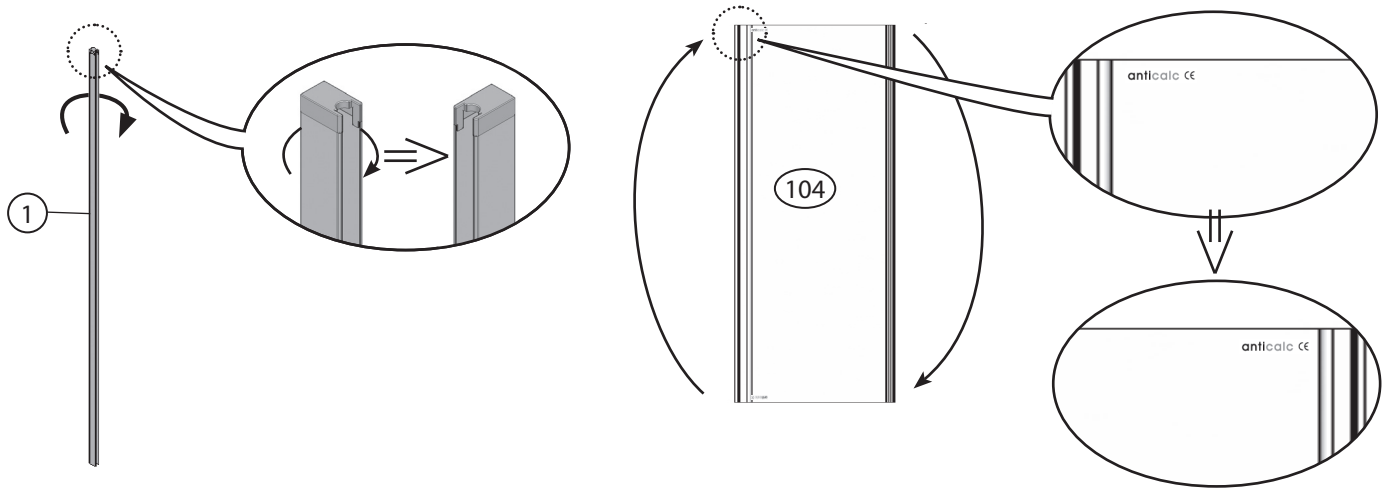

3

CPS

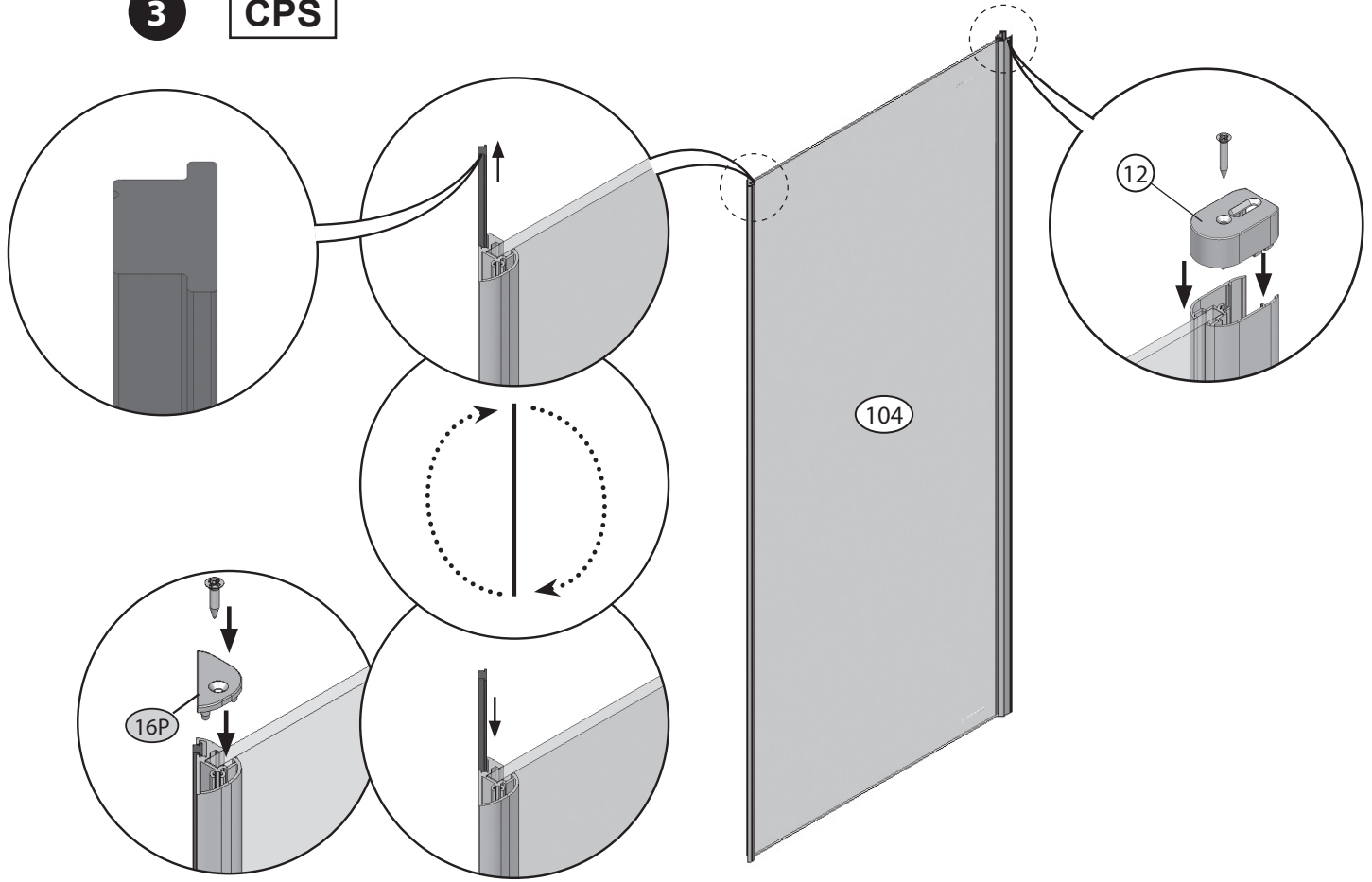

4

CRV1

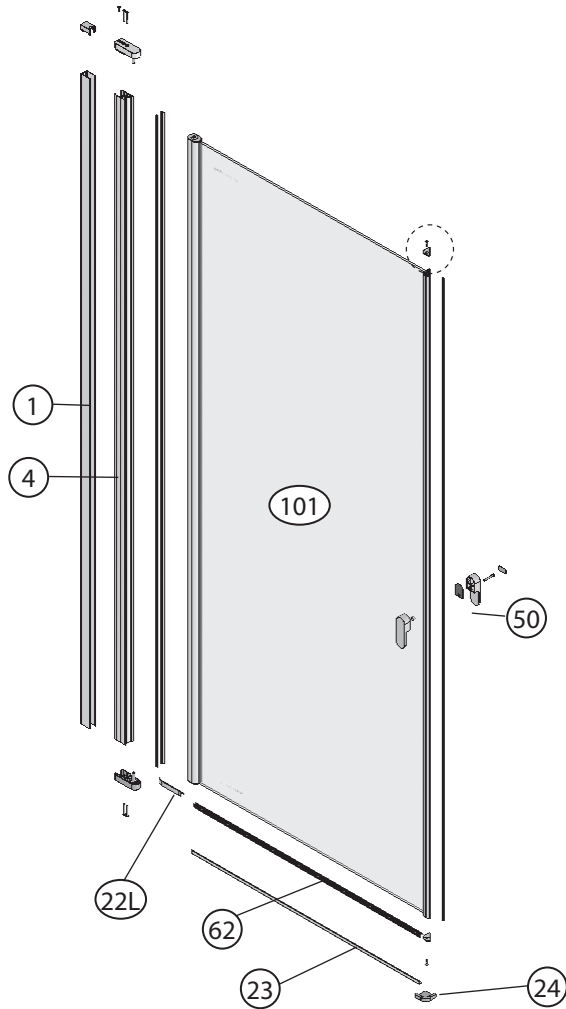

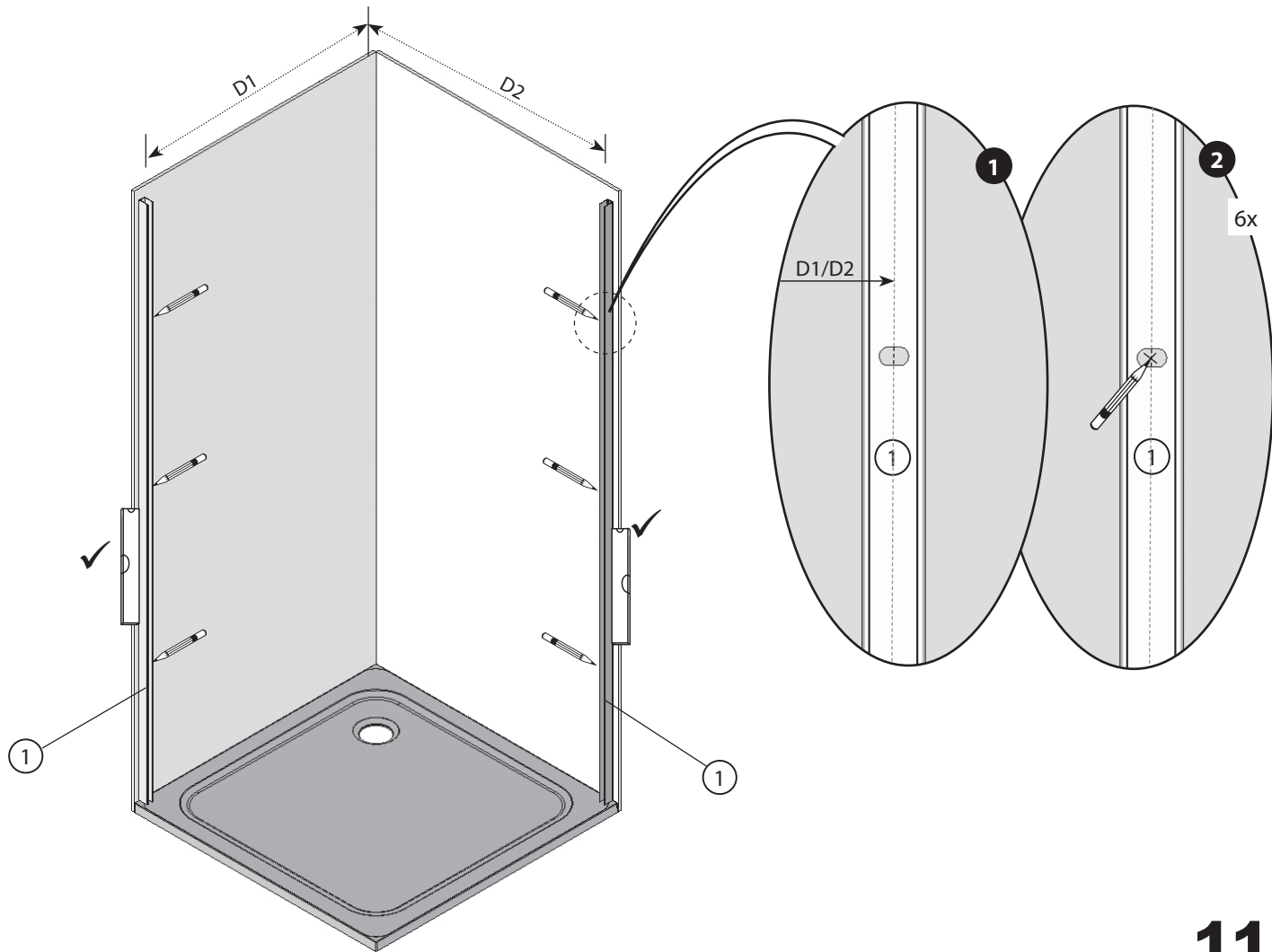

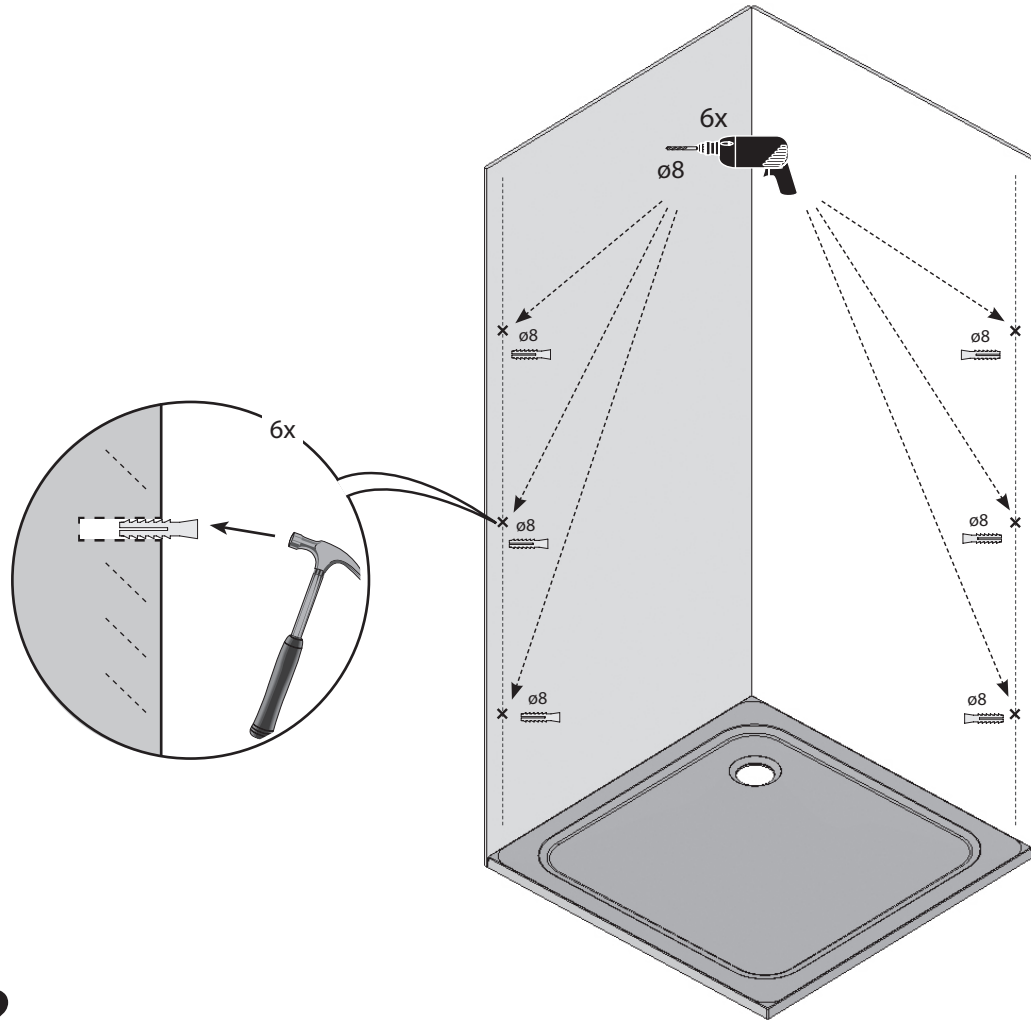

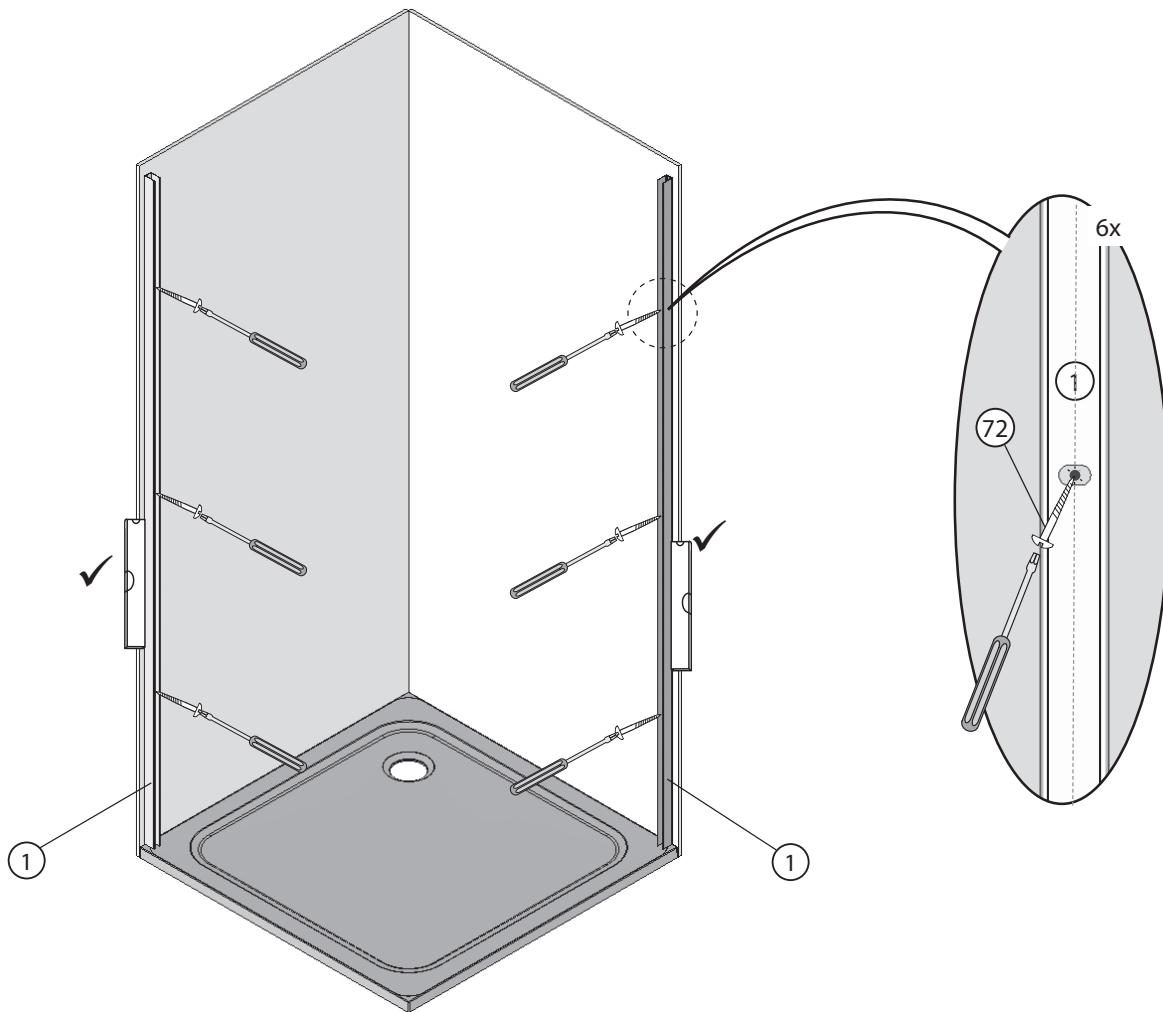

14

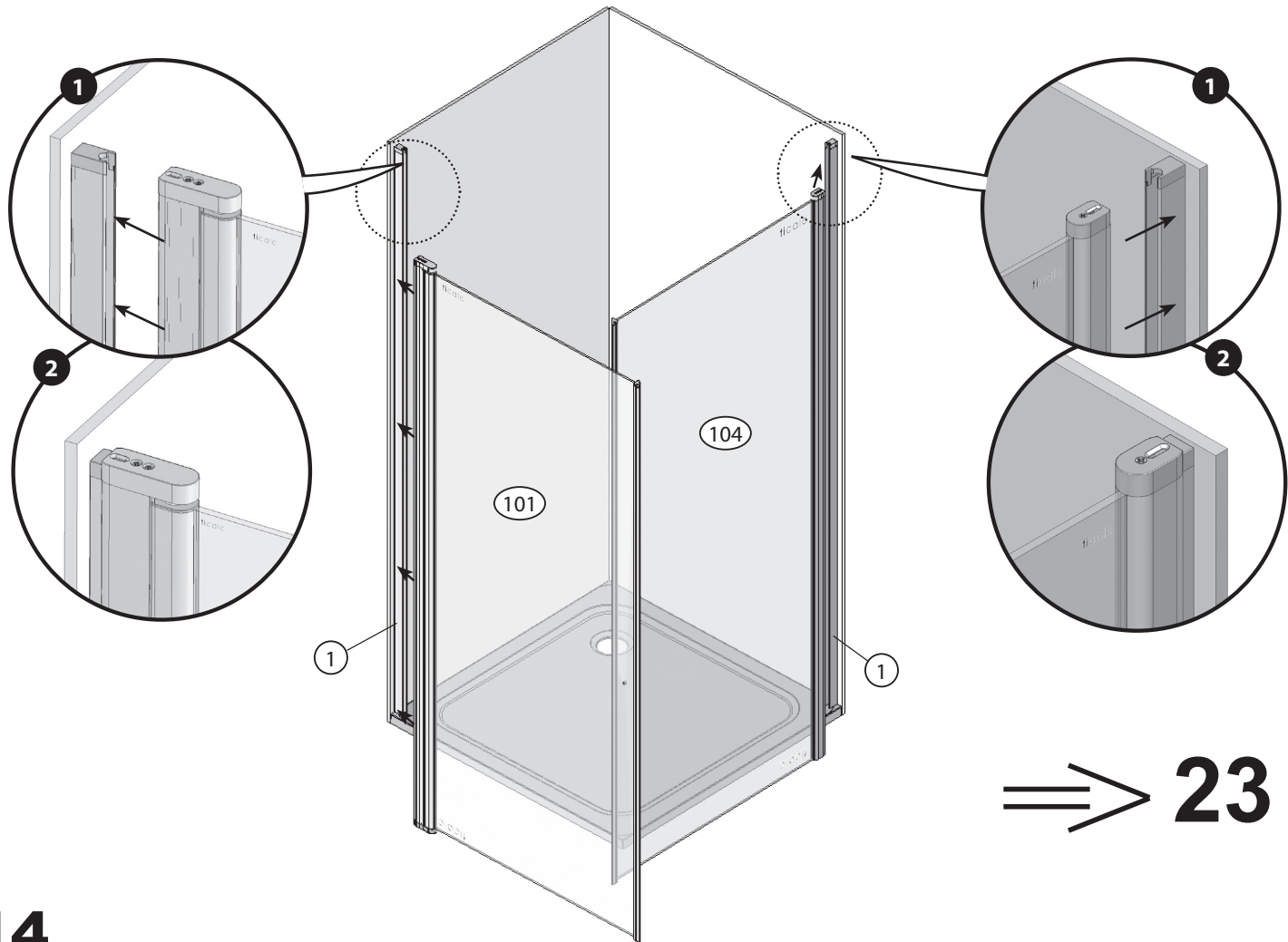

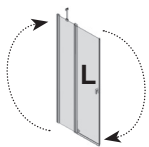
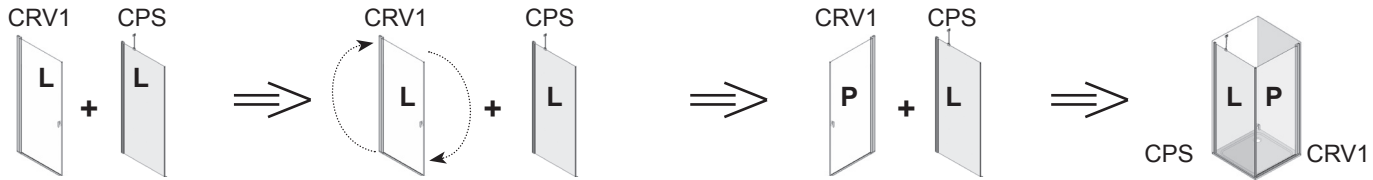

How to make right side door from one left side door.



1

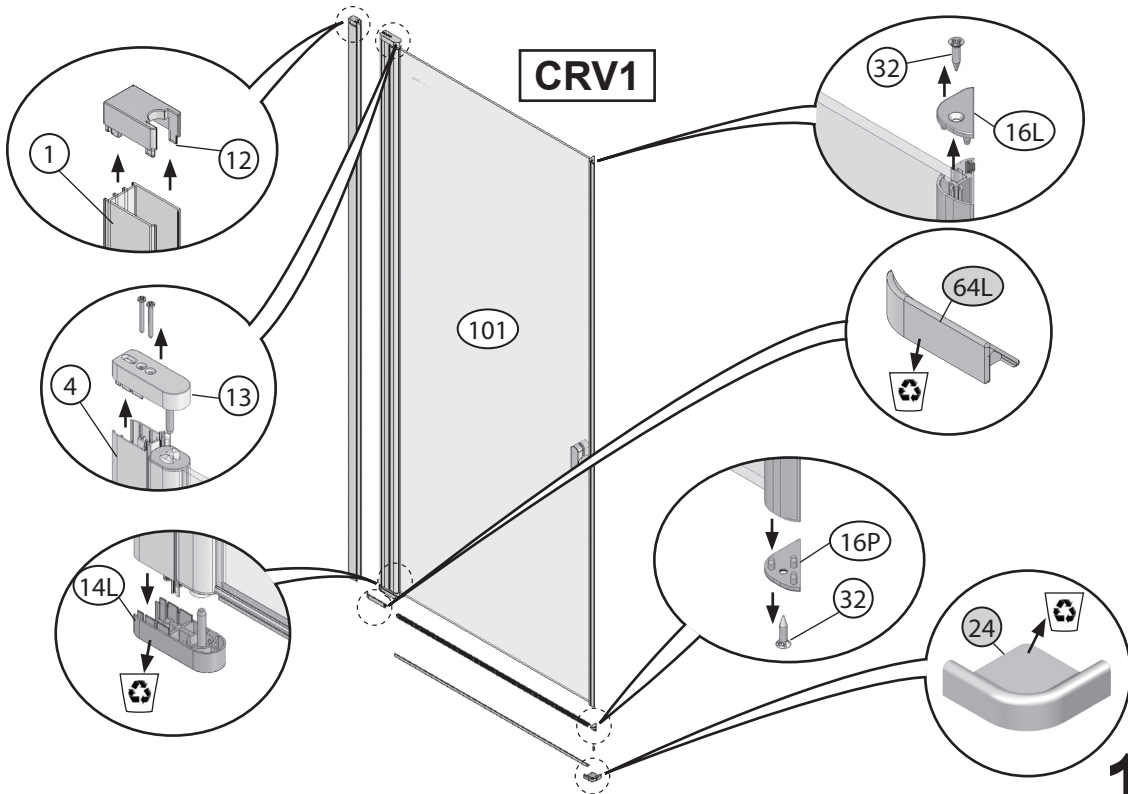

15

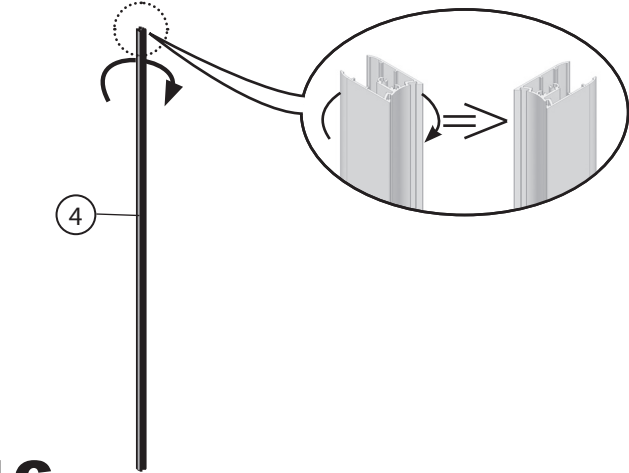
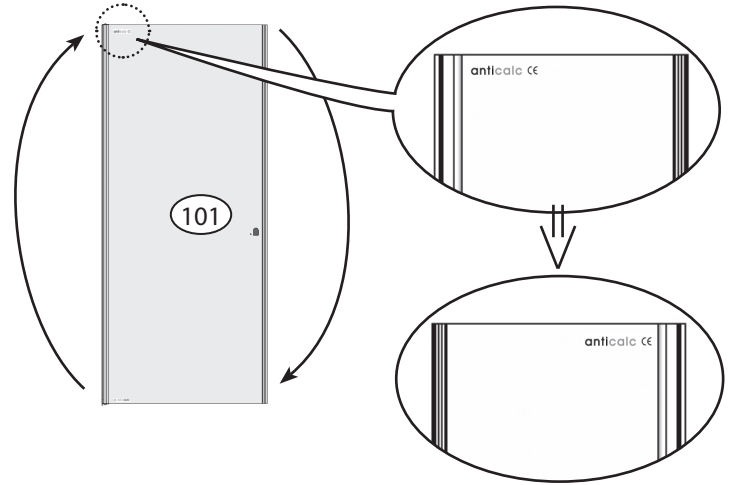
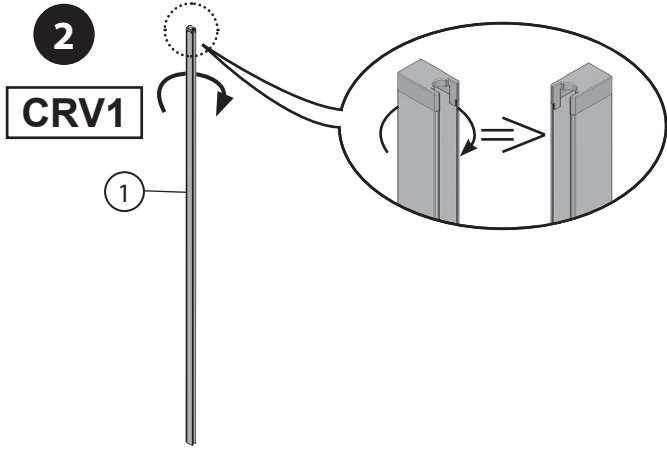

3 CRV1

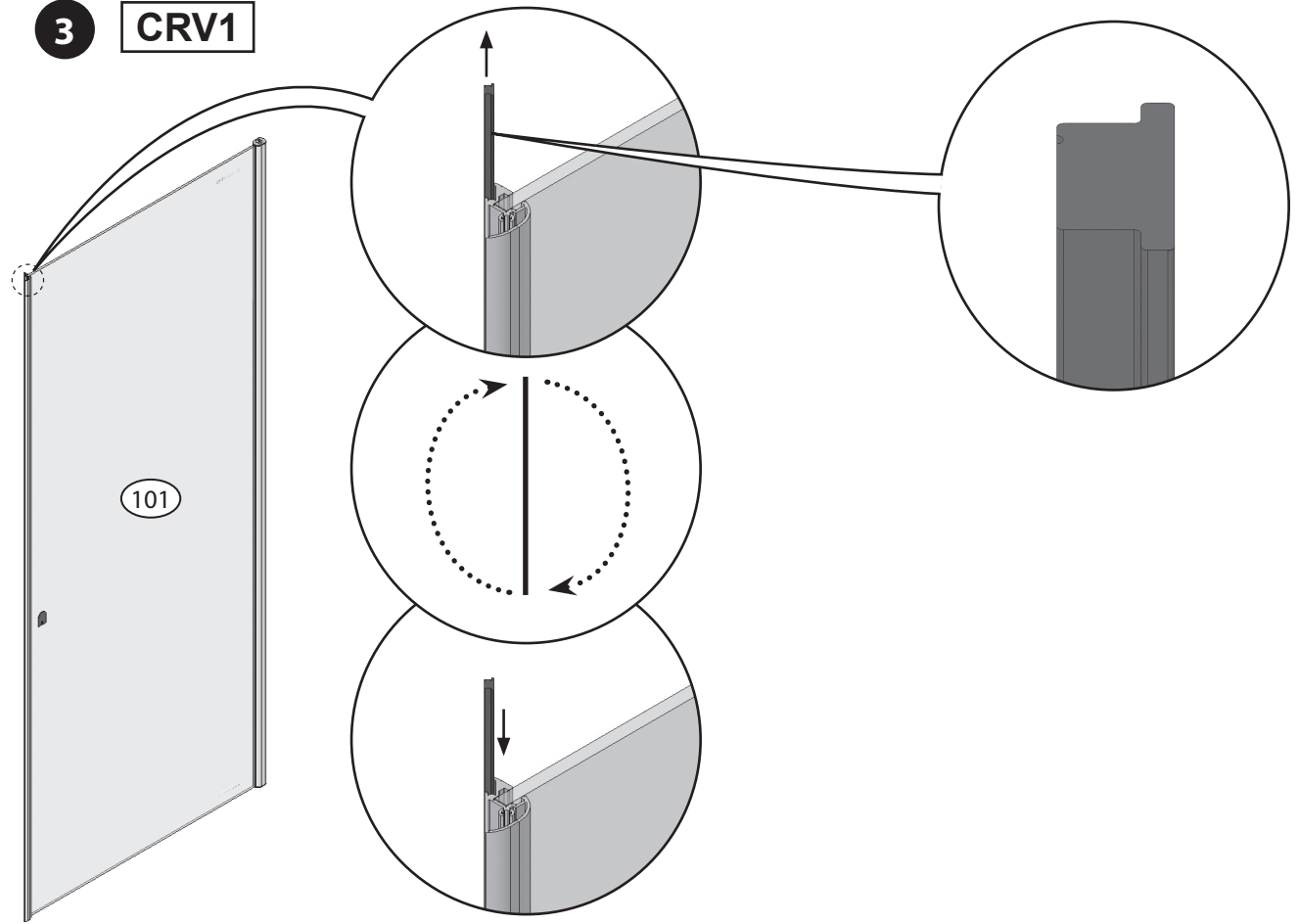

4

CRV1

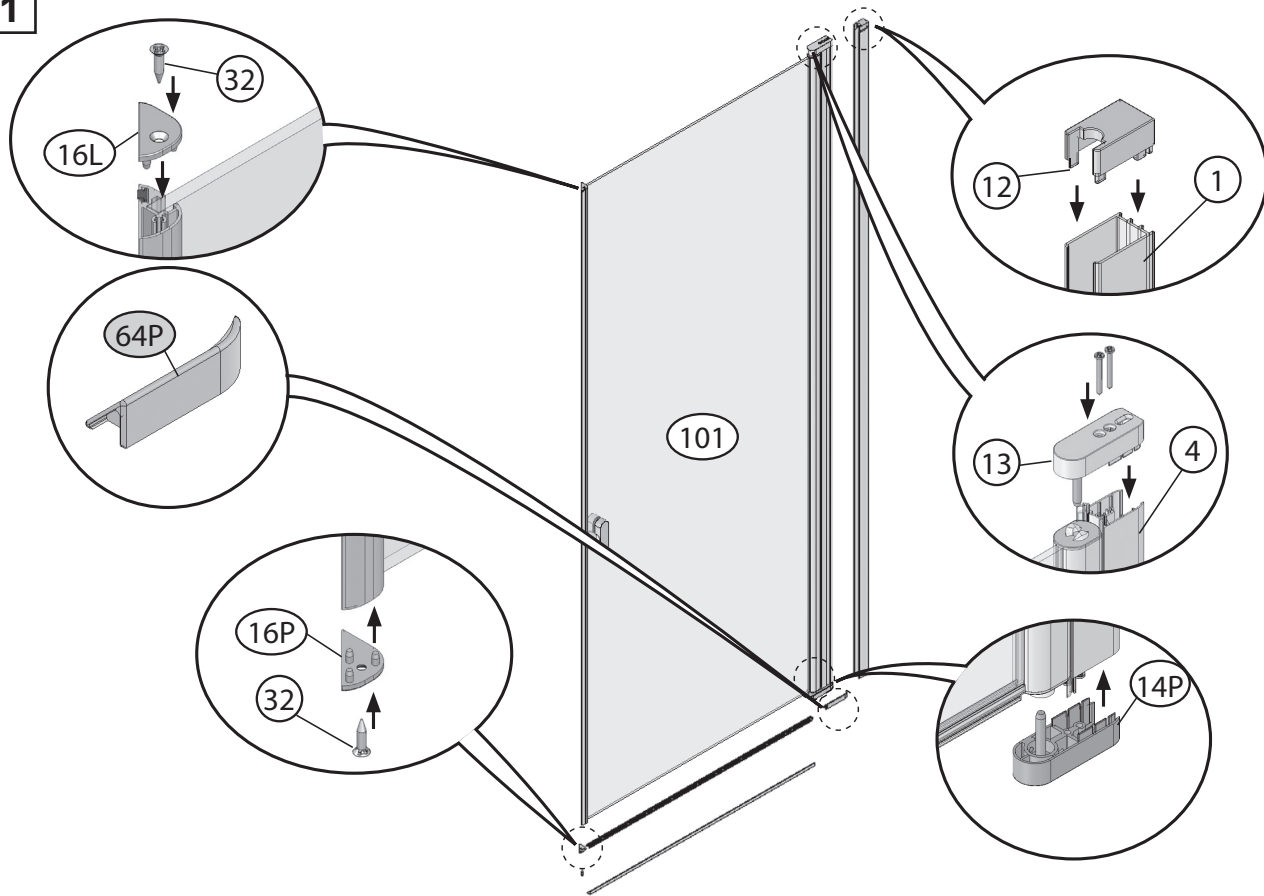

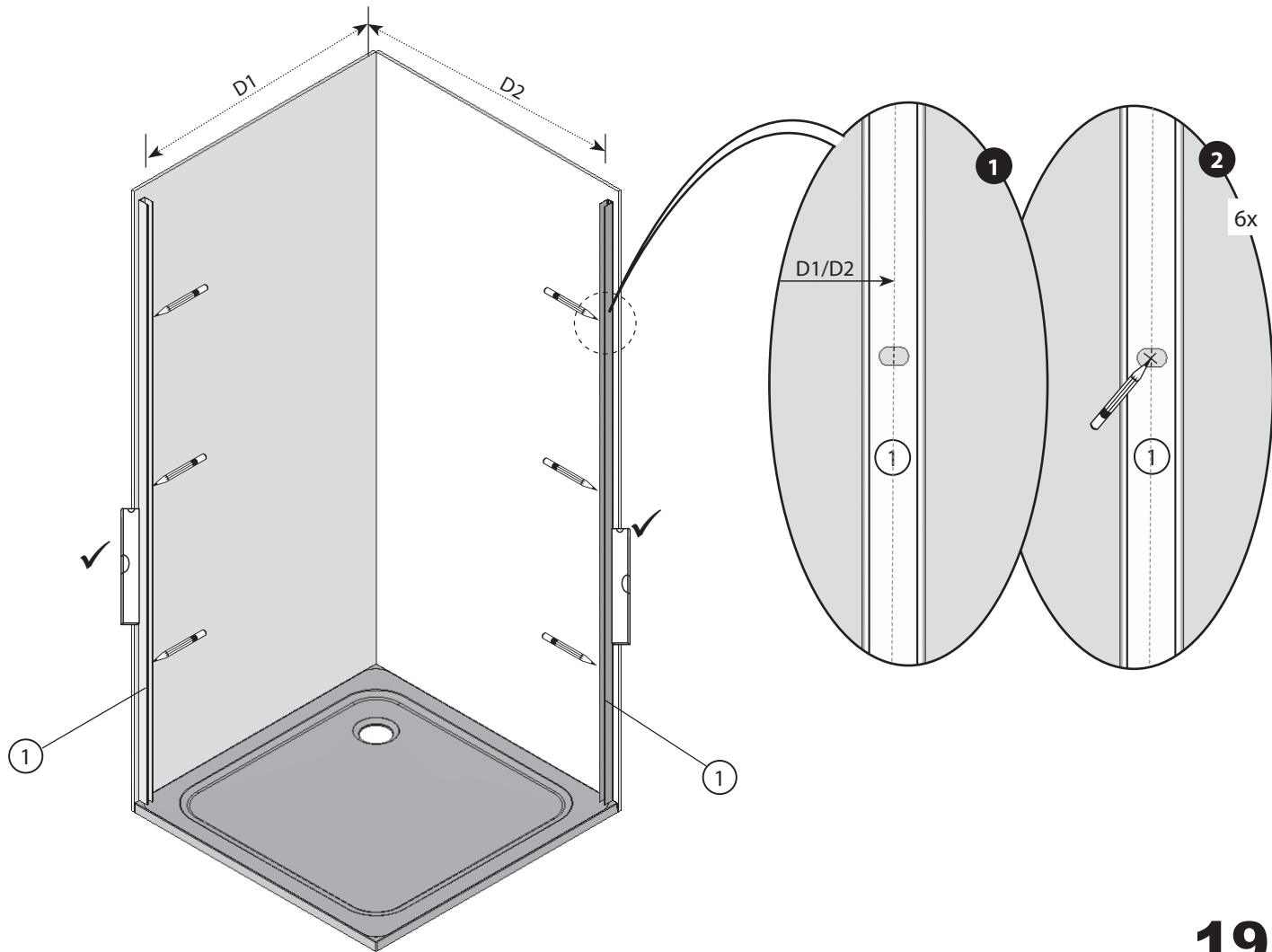

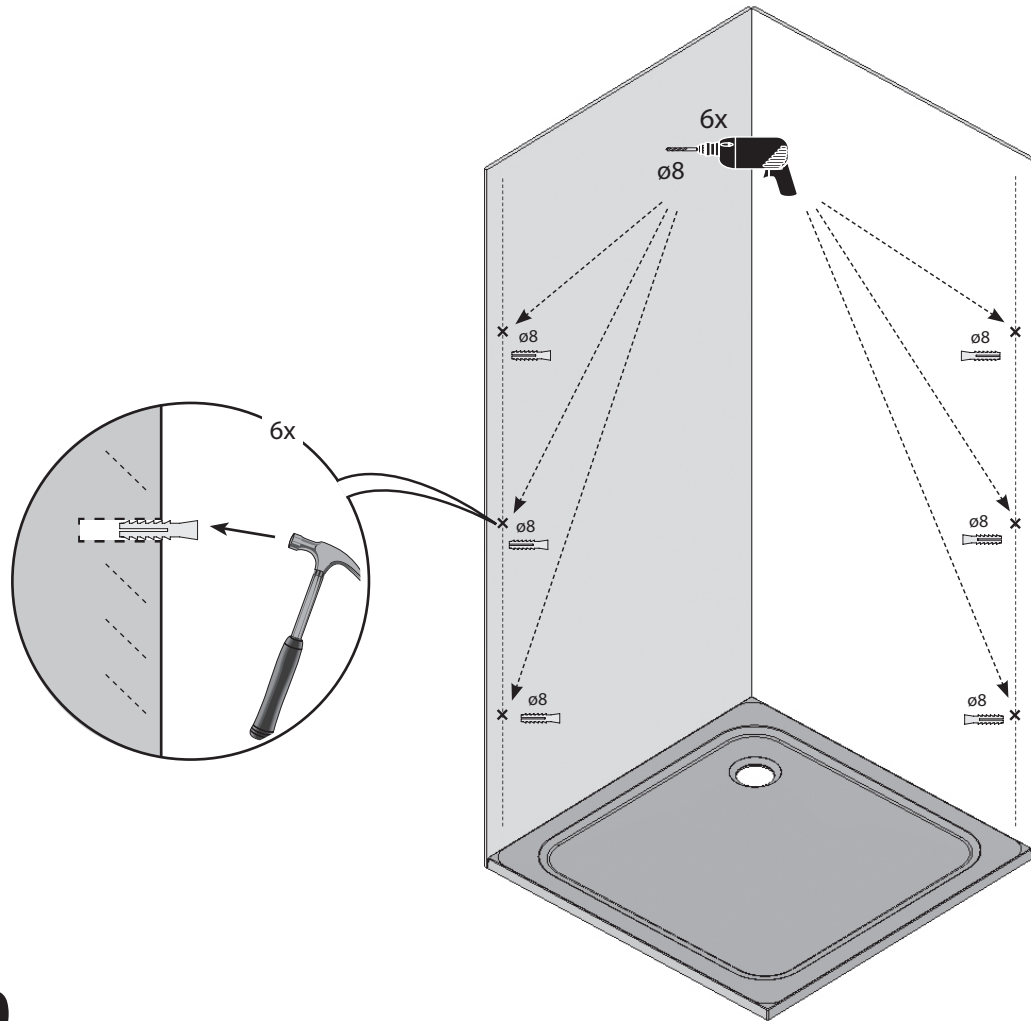

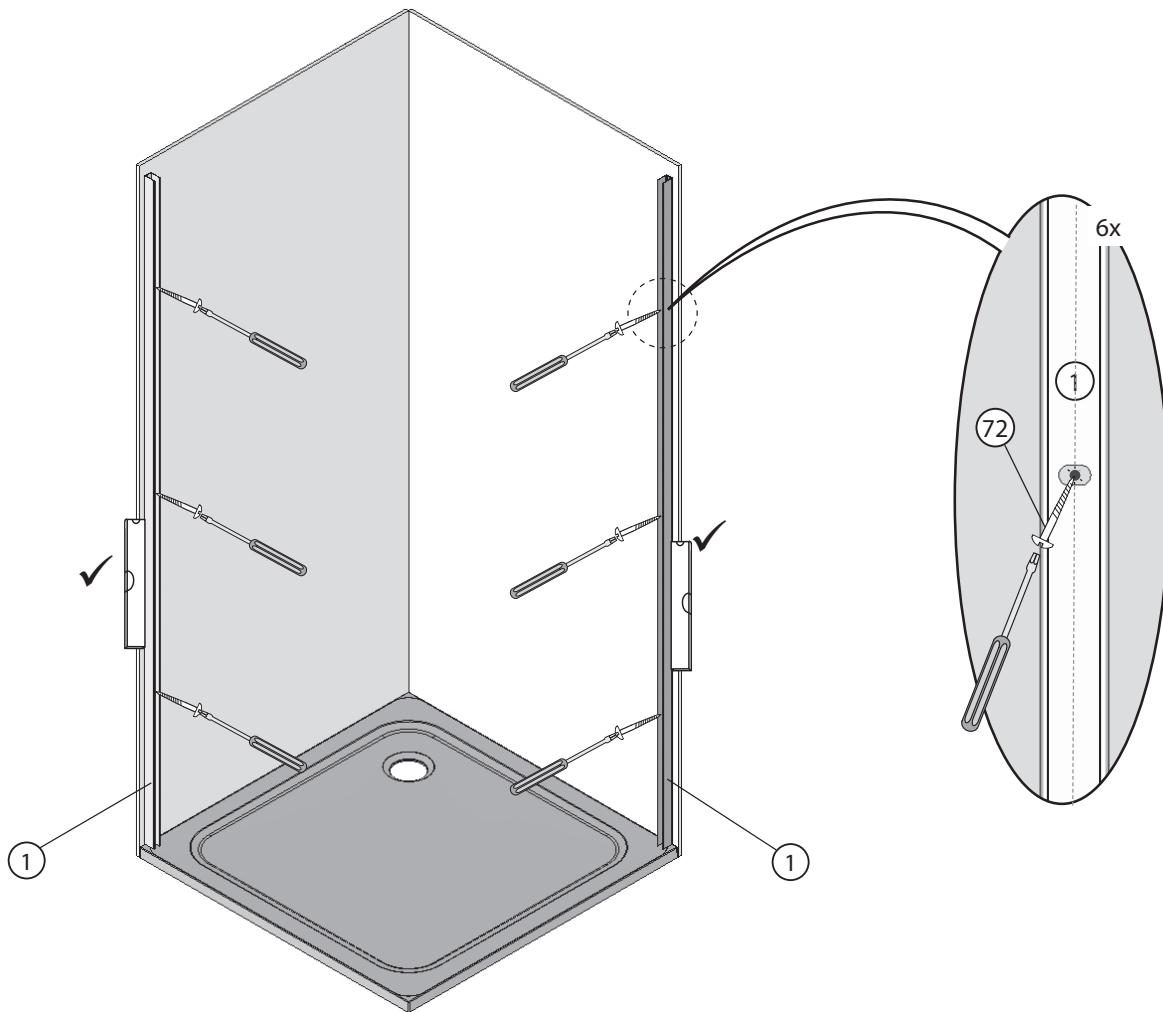

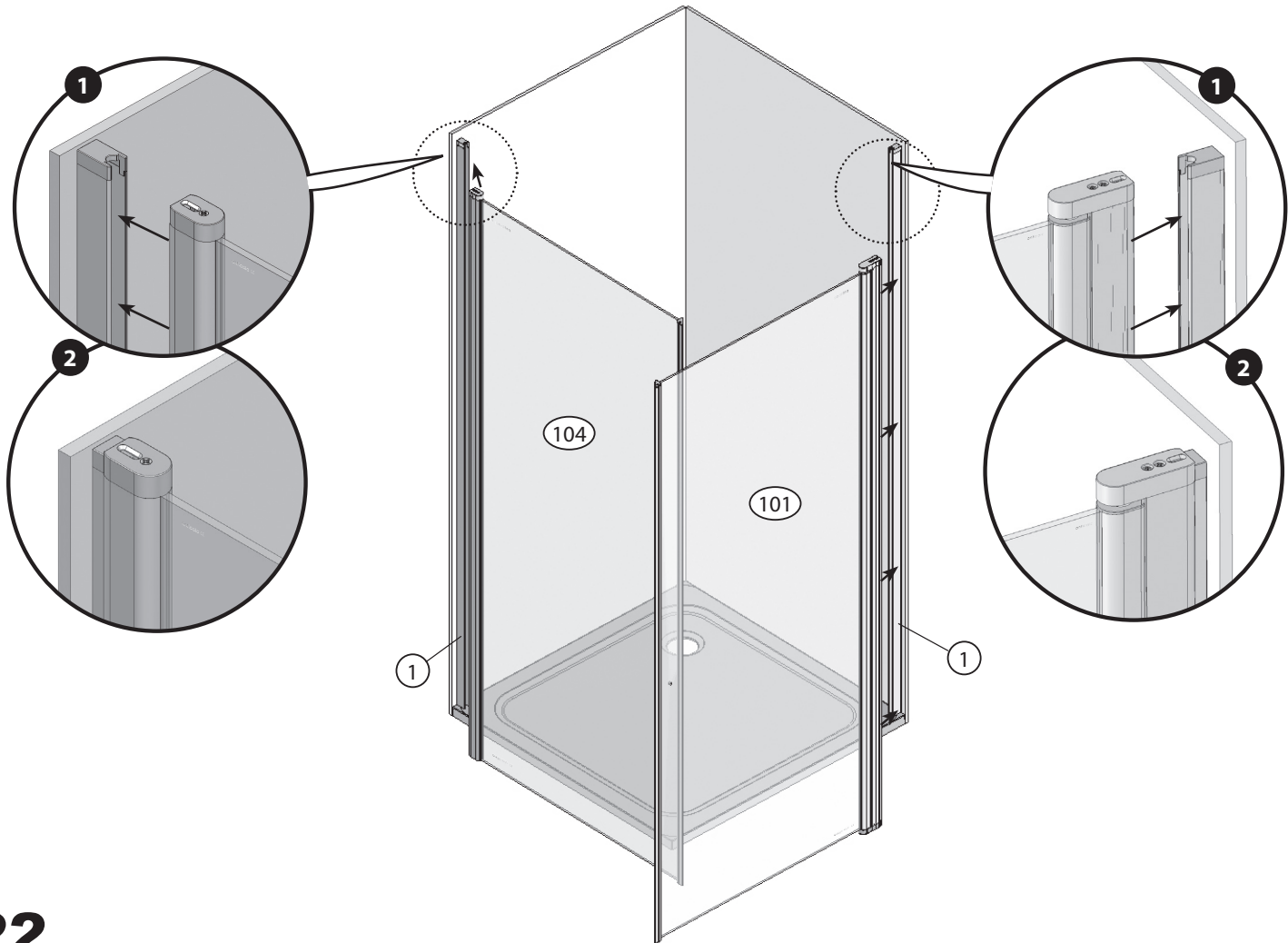

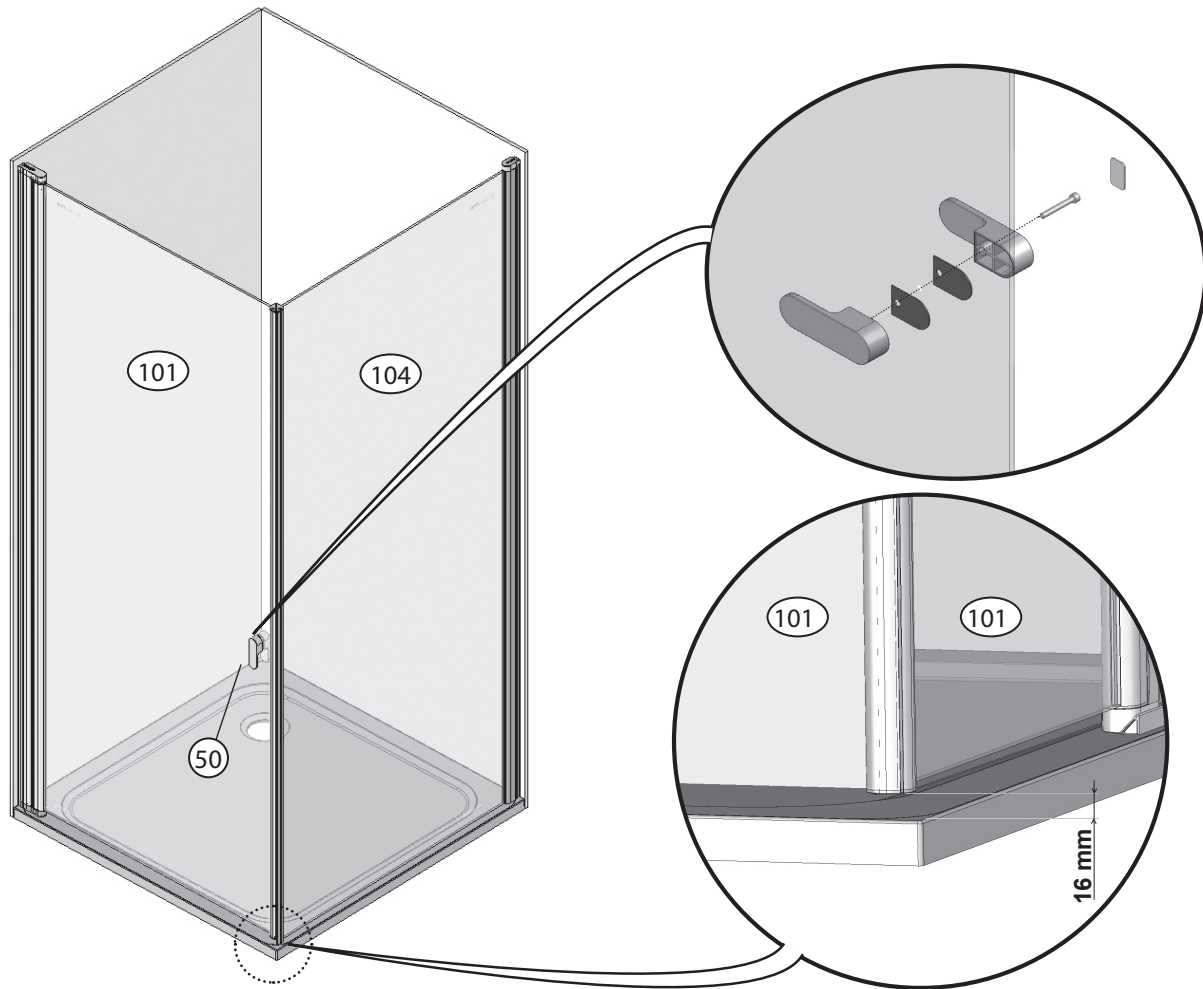

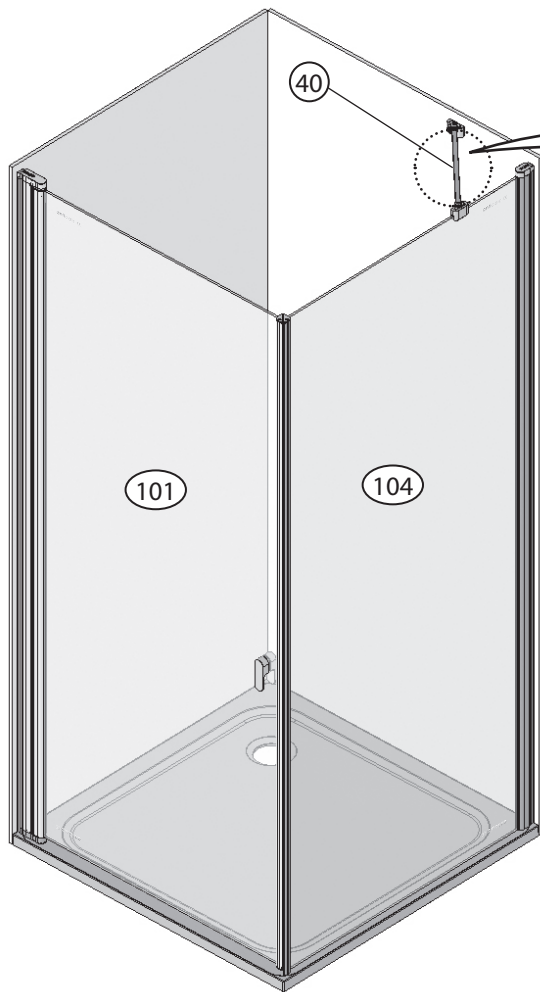

CPS 80/90 ±195 mm
CPS 100 ±245 mm

